

**Maxwell Road, Borehamwood**

**£1,500 Per Month ( )**



**AVAILABLE NOW!!** Gas and electricity are included in the rent!

Available Now – 1 Bedroom Apartment to Let in Borehamwood

A well-presented one-bedroom, first-floor apartment ideally located in Borehamwood, just a short stroll from excellent local amenities. These include the large Tesco Extra Borehamwood, the bustling high street, places of worship, and the mainline station. The property is also perfectly positioned within the catchment area for highly regarded schools, including Yavneh College and Yavneh Primary.

The apartment is available for immediate occupation and comprises:

- Entrance hall
- Good-sized double bedroom
- Modern bathroom
- Open-plan kitchen/living/dining area with fitted integrated appliances, washer/dryer, fridge/freezer, and cooker

Externally, the property benefits from a private balcony accessed from the living area, as well as an allocated parking space for one car.

Early viewing is highly recommended.

**020 3764 2222**  
[www.village-estates.co.uk](http://www.village-estates.co.uk)



Village Estates  
The Corner Shop High Street, Elstree  
Herts WD6 3BY

**Important Note:** These particulars do not form part of any contract. All measurements are approximate and should not be relied upon. All prices quoted are strictly subject to contract.





Approx Gross Internal Area  
43 sq m / 467 sq ft

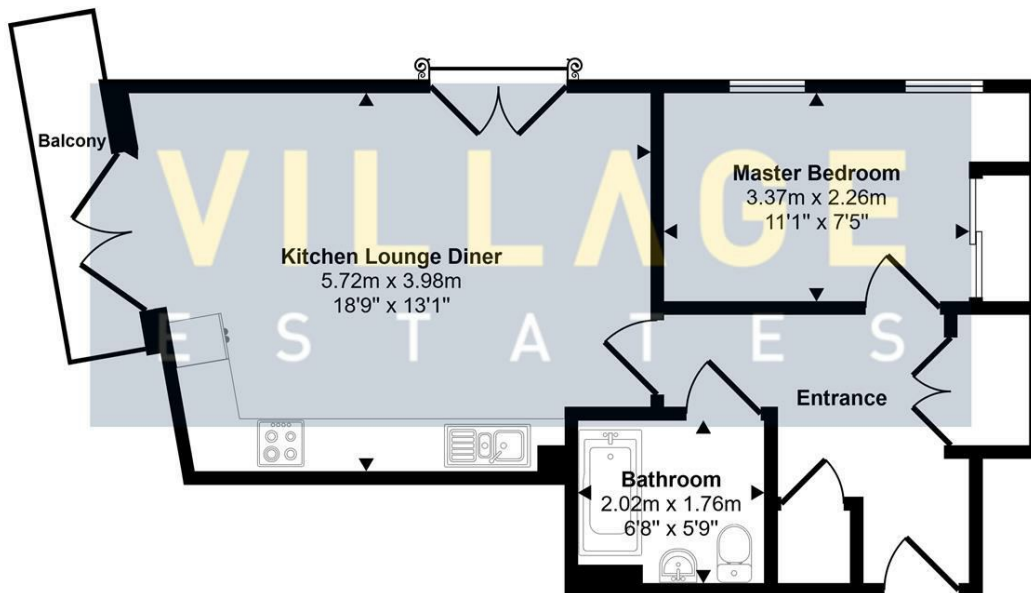

Floorplan

This floorplan is only for illustrative purposes and is not to scale. Measurements of rooms, doors, windows, and any items are approximate and no responsibility is taken for any error, omission or mis-statement. Icons of items such as bathroom suites are representations only and may not look like the real items. Made with Made Snappy 360.



Energy Efficiency Rating		Current	Potential
Very energy efficient - lower running costs			
(92 plus) <b>A</b>			
(81-91) <b>B</b>			
(69-80) <b>C</b>			
(55-68) <b>D</b>			
(39-54) <b>E</b>			
(21-38) <b>F</b>			
(1-20) <b>G</b>			
Not energy efficient - higher running costs			
<b>England &amp; Wales</b>		EU Directive 2002/91/EC	